

ADDENDUM NO. 5

January 29, 2019

FOR

Williston Regional Water Treatment Plant Pretreatment – Part 3

FOR

Western Area Water Supply Authority
Williston, North Dakota

July 2018



This Addendum No. 5 forms a part of the Contract Documents and modifies the original Bidding Documents as noted within this Addendum. All provisions of the Contract Documents not in conflict with this Addendum shall remain in full force. Acknowledge receipt of this Addendum in the space provided on the Bid Form. Failure to do so may subject the Bidder to disqualification.

This addendum consists of two (2) pages and one (1) attachment.

Changes to the Specifications: N/A

Changes to the Drawings:

- 1) **Drawing A6 Delete** Ladder shown from walkway 120 down to S116.
- 2) **Structural Drawings Change** all references to guardrail or handrail to 2 rail aluminum.
- 3) **Drawing S6 change** reference detail in Note 5 from 3/S4 to 5/S12.
- 4) **Drawings S13, S14, S15 and S16: All** platform materials to be anodized aluminum.
- 5) **Drawing S6 and S12** Grating support members over plate settler basin shall be 50 KSI steel sections.
- 6) **Structural Drawings: All** aluminum materials are to be anodized.
- 7) **Drawing P8: Add** the following to Construction Note 3; "Connection to existing will require one 90 degree bend and approximately 8 feet of pipe."
- 8) **Drawing P10: Change** Process Improvement Note 2 shown on Detail 2/P10 to Construction Note 2.
- 9) **Drawing P10 Section 1/P10 check valve shall be:** Swing Check, non-slamming design:
Approved Manufacturer and type:
 - A. APCO Series 6000 Cushion Swing Check Valve manufactured by Valve and Primer Corp.
 - B. SWC Series Cushion Swing Check Valve manufactured by Crispin Valve.
 - C. Approved Equivalent.
- 10) **Drawing P10: Section 3/P10 add** short spool piece between horizontal tees as shown in Plan 1/P10.
- 11) **Drawing P10: Section 4/P10 Add** the following note: "Valve Actuator shall be Rotork IQ20/25, IB5, F14/F16/F14/F16 with Top Wheel Handwheel or Equal added to existing 8 inch gate valve"

- 12) **Drawing P12: Change** Construction Note 1 to read "Contractor shall core drill existing concrete wall, install pipe sleeve and link seal as required to connect to vacuum sludge collector."
- 13) **Drawing P14: Change Pipe note 16 to read:** 8 inch DI Pipe at approximate elevation of 1924.00.
- 14) **Drawings P15 and P17: Replace** existing drawings P15 and P17 with attached revised drawings.
- 15) **Drawing E21: Add the following equals to the fixture schedule:**
 - a. Fidelux FRHB as an equal to fixture types A and AE
 - b. LSI industries EG3 to type B and BE
 - c. Solas Ray HNL4 to type C,
 - d. LSI industries TMWP to type D
 - e. LSI industries MRM LED to type F
 - f. LSI industries EVW to type X

END OF ADDENDUM NO. 5



SYM	DATE	DESCRIPTION	APPR
Δ	JAN 2019	CLARIFY EXISTING	PAJ

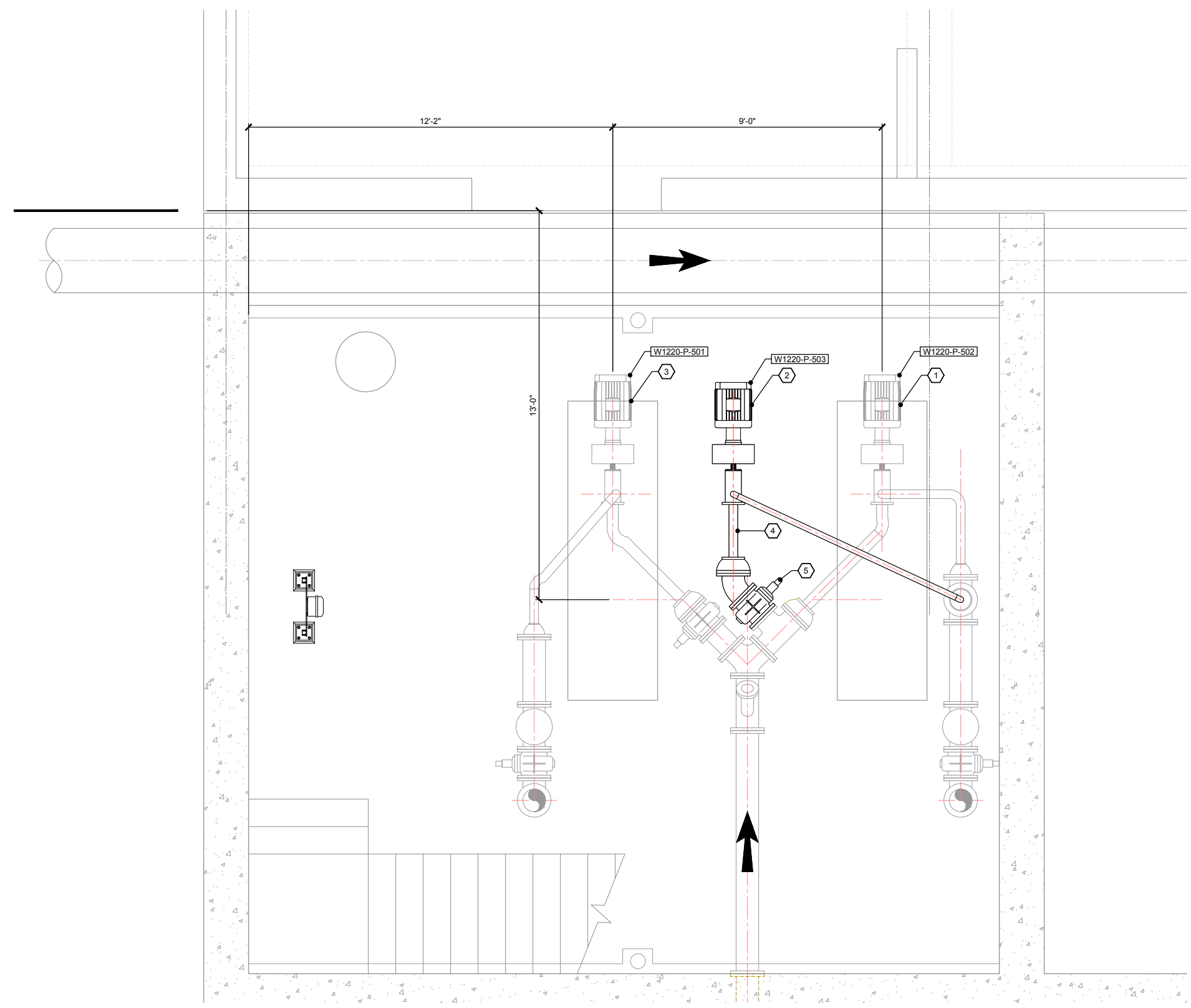

- CONSTRUCTION NOTES**
- ① EXISTING SLUDGE PUMP TO REMAIN.
 - ② RELOCATE PUMP FROM ADJACENT POSITION.
 - ③ NEW 4 x 3 CENTRIFUGAL SLUDGE PUMP.
 - ④ NEW PIPING TO BE DETERMINED IN THE FIELD
 - ⑤ NEW 8" PLUG VALVE

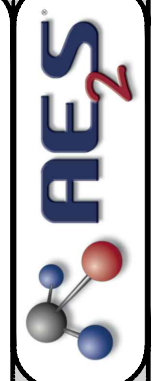

PRETREATMENT - PART 3
 WILLISTON REGIONAL WATER TREATMENT PLANT
 WILLISTON, NORTH DAKOTA
 SUBGRADE LEVEL ENLARGED PLAN - SCB, SLUDGE TANK, & RECARB BASIN

1
P15
 ENLARGED SUBGRADE LEVEL PLAN
 SLUDGE TANK AND PUMP AREA
 REF: P10

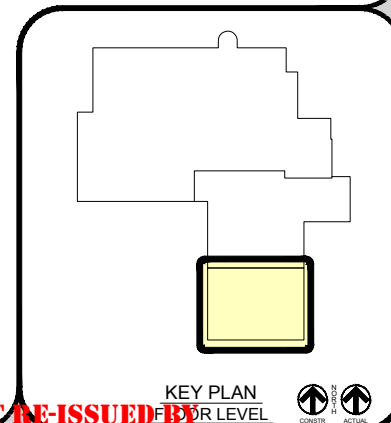
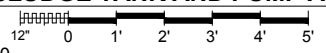

DRAWING TYPE	Const
PREPARED BY	KW
CHECKED / APPROVED	RDG / PAJ
DATE	JULY, 2018
PROJECT NUMBER	P10670-2017-022
SHEET	15 of 19
DRAWING	P15

**SHEET AS ISSUED BY
 ADDENDUM 5**



Layout: P14 CHEMICAL FEED SCHEMATICS
File: \\WVA\WVA\SAN\0670-2017-022\CAD Dwg\04-Process\A\A\04a\01\Plan Sheets\CHEMICAL FEED SCHEMATICS.dwg

Plotted By: Kelly Wooster Date: Friday, January 25, 2019 11:20 AM
Last Saved By: Kelly Wooster Date: Friday, January 25, 2019 11:20 AM

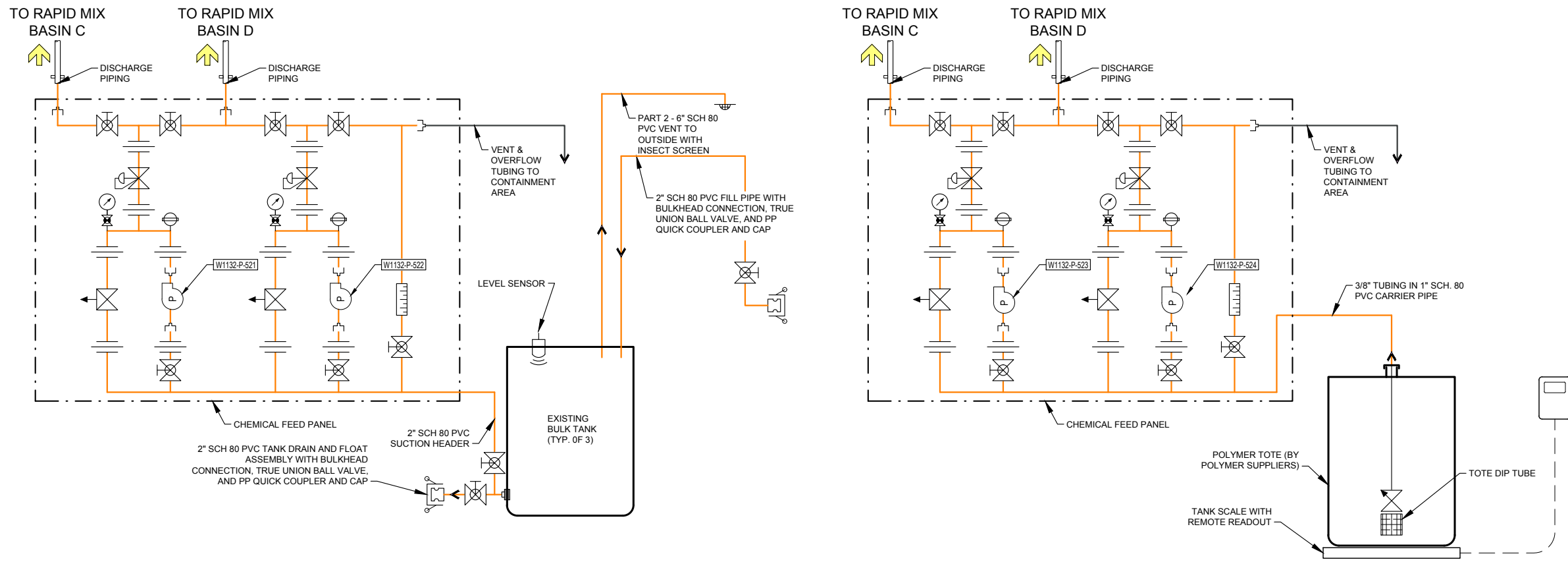

1 ALUM CHEMICAL FEED SCHEMATIC
P17 NONE

2 NEAT POLYMER FEED SCHEMATIC
P17 NONE

NOTE: CHEMICAL TANKS, SCALES, AND POLYMER BLENDER ARE EXISTING EQUIPMENT. EQUIPMENT TO BE FURNISHED AND INSTALLED UNDER THIS PROJECT ARE THE CHEMICAL PUMP SKIDS AND SUCTION AND DISCHARGE PIPING.

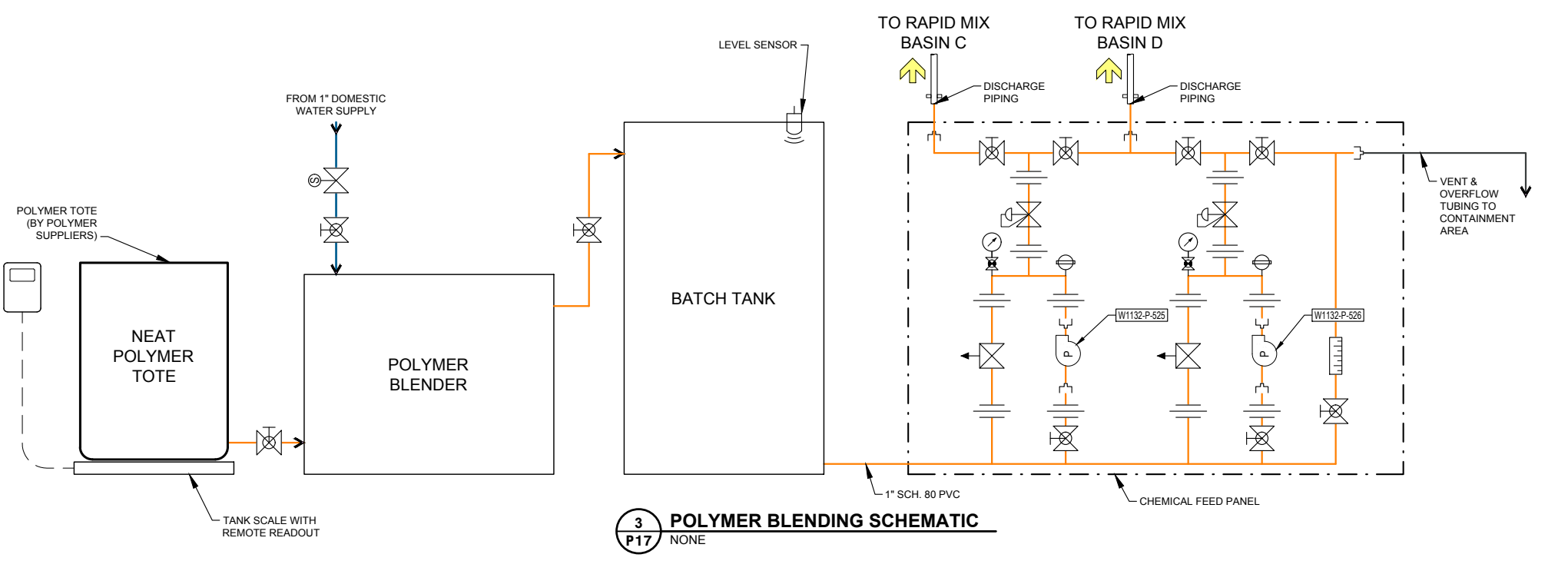

3 POLYMER BLENDING SCHEMATIC
P17 NONE



- CHEMICAL FEED NOTES**
1. CHEMICAL FEED PANEL PIPING SHALL BE 1/2" SCH 80 PVC.
 2. ALL OTHER PIPING SHALL BE 3/8" O.D. TUBING IN 1" SCH. 80 PVC CARRIER PIPE, UNLESS OTHERWISE SPECIFIED.
 3. ALL TANK CONNECTIONS TO BE AIR TIGHT AND LEAK RESISTANT.
 4. EXACT ROUTING OF CHEMICAL FEED LINES TO BE DETERMINED IN FIELD WITH OWNER AND ENGINEER INPUT.
 5. PRESSURE RELIEF, BACKPRESSURE, AND VALVING DIRECTLY ASSOCIATED WITH CHEMICAL FEED PUMP OPERATIONS SHALL BE PROVIDED BY CHEMICAL FEED PUMP SUPPLIER AND MAY NOT ALL BE IDENTIFIED IN SCHEMATICS. REFER TO PROJECT MANUAL SECTION 11260.
 6. ALL EQUIPMENT, PIPING, AND MATERIALS THAT COULD COME IN CONTACT WITH THE CHEMICAL SHALL BE FULLY COMPATIBLE WITH THE LIQUID SOLUTION.
 7. COORDINATE LOCATION OF WALL MOUNTED INDICATORS AND PUMP PANELS WITH OWNER AND ENGINEER.

PAJ

SYM	DATE	DESCRIPTION	APPR

JAN 2019 CLARIFY EXISTING

PRETREATMENT - PART 3
WILLISTON REGIONAL WATER TREATMENT PLANT
WILLISTON, NORTH DAKOTA

CHEMICAL FEED SCHEMATICS

DRAWING TYPE
Const
PREPARED BY
RDG / KW
CHECKED / APPROVED
RDG / PAJ
DATE
JULY, 2018
PROJECT NUMBER
P10670-2017-022
SHEET
16 of 19
DRAWING
P17